

 torso
doors



DOORS FOR THE PERFECT HOME
RELIABILITY. HIGH QUALITY

TABLE OF CONTENT

optimal

Natural plywood, exterior doors

04

dimensions

Standard size table

07

optimal

Painted, exterior doors

08

master plus

Additional accessories

10

master plus

Available designs

14

dimensions

Standard size table

16



GENERAL INFORMATION

Use	Product of plywood natural surface for externally use
Marking	-
Standard accessories	Lock case: ASSA-565; hinges: 3248 - 2 pcs.; Lock plate: 0034 ZN; Silicone-based sealing strip.
Glass	Transparent single chamber glass packet (double glass -12mm) with pine wood glass list
Frames	The frame set is included. 42x92NOR pine wood
Thresholds	The threshold is included. 42x92NOR pine wood
Other accessories and services	There is a possibility to choose other accessories and services according optimal plus and master plus, but the quantity of products must meet the requirements of the optimal category
Units per pallet	11 pcs. a pallet consist one model and one size to all products

Features of door construction



MASSIVE CONSTRUCTION

Massive frame construction for external products, polystyrene used in the construction allows to ensure low thermal transmittance



DOOR LEAF THICKNESS

The door leaf thickness is 40mm



THERMAL TRANSMITTANCE

Supports 15°C building heat between outdoor and indoor temperature



SOUND RESISTANCE

Door leaf structure is produced for sound resistance up to 25dB



NON STANDARD DIMENSIONS

The product may be produced in non-standard sizes



UNTREATED PRODUCT

Product is not treated in any way for UV and moisture protection. After purchase, the product must be treated such as paint, lacquer or oil



REPAINTING POSSIBILITY

Product is suitable for repainting of any type and in any manner



DIFFERENT COLORS OPTION

The product can be painted in other colors by choosing from the NCS and RAL color palette



WARRANTY

3 year quality guarantee provided by manufacturer

optUdhusdør Eco



optUdhusdør Eco
Dobbelt Fixed

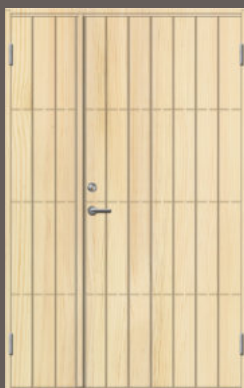

optUdhusdør Eco
Dobbelt

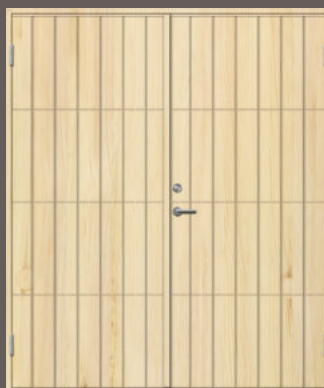

optUdhusdør Glat



optUdhusdør Glat
Dobbelt Fixed



optUdhusdør Glat
Dobbelt



optUdhusdør



optUdhusdør
Dobbelt Fixed

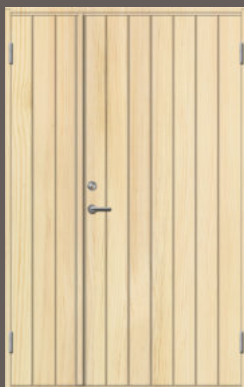

optUdhusdør
Dobbelt



1. Finger jointed pine wood frame
2. Wood cap
3. Polystyrene core
4. Plywood panels surface 4mm
5. Wood
6. Threshold

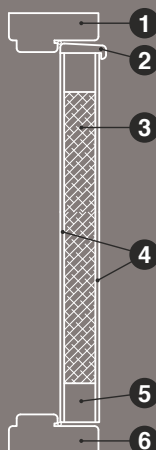

optUdhusdør Eco
glass



optUdhusdør Eco
glass Dobbelt Fixed

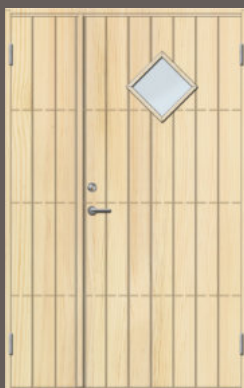

optUdhusdør Eco
glass Dobbelt

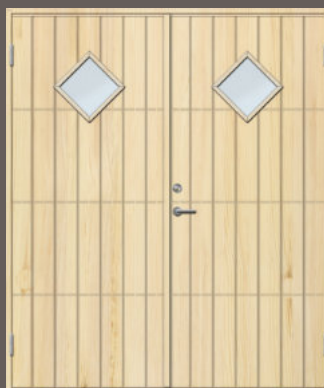

optUdhusdør Glat
glass



optUdhusdør Glat
glass Dobbelt Fixed



optUdhusdør Glat
glass Dobbelt



optUdhusdør
glass



optUdhusdør
glass Dobbelt Fixed



optUdhusdør
glass Dobbelt

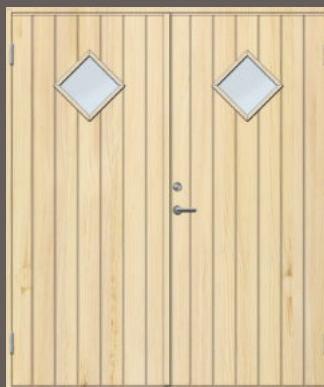

1. Finger jointed pine wood frame
2. Wood cap
3. Polystyrene core
4. Single-chamber glass unit (double glass)
5. Wood glass list
6. Plywood panels surface 4mm
7. Wood
8. Threshold

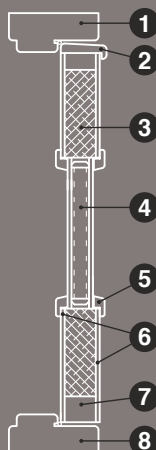

Natural plywood, single door dimensions table (mm)

M Size	Door leaf size	Frame outside dimension	Door way
19 x 8 M	1827 x 725	1889 x 786	1900 x 800
19 x 9 M	1827 x 825	1889 x 886	1900 x 900
19 x 10 M	1827 x 925	1889 x 986	1900 x 1000
20 x 8 M	1927 x 725	1989 x 786	2000 x 800
20 x 9 M	1927 x 825	1989 x 886	2000 x 900
20 x 10 M	1927 x 925	1989 x 986	2000 x 1000
21 x 8 M	2027 x 725	2089 x 786	2100 x 800
21 x 9 M	2027 x 825	2089 x 886	2100 x 900
21 x 10 M	2027 x 925	2089 x 986	2100 x 1000

Natural plywood, double door dimensions table (mm)

M Size	Door leaf size	Frame outside dimension	Door way
19 x 13 M	1827 x 661/561f	1889 x 1286	1900 x 1300
19 x 14 M	1827 x 711/611f	1889 x 1386	1900 x 1400
19 x 15 M	1827 x 761/661f	1889 x 1486	1900 x 1500
19 x 13.9 M	1827 x 925/409f	1889 x 1398	1900 x 1412
19 x 14.9 M	1827 x 925/509f	1889 x 1498	1900 x 1512
19 x 17 M	1827 x 825/825f	1889 x 1714	1900 x 1728
19 x 19 M	1827 x 925/925f	1889 x 1914	1900 x 1928
20 x 13 M	1927 x 661/561f	1989 x 1286	2000 x 1300
20 x 14 M	1927 x 711/611f	1989 x 1386	2000 x 1400
20 x 15 M	1927 x 761/661f	1989 x 1486	2000 x 1500
20 x 13.9 M	1927 x 925/409f	1989 x 1398	2000 x 1412
20 x 14.9 M	1927 x 925/509f	1989 x 1498	2000 x 1512
20 x 17 M	1927 x 825/825f	1989 x 1714	2000 x 1728
20 x 19 M	1927 x 925/925f	1989 x 1914	2000 x 1928
21 x 13 M	2027 x 661/561f	2089 x 1286	2100 x 1300
21 x 14 M	2027 x 711/611f	2089 x 1386	2100 x 1400
21 x 15 M	2027 x 761/661f	2089 x 1486	2100 x 1500
21 x 13.9 M	2027 x 925/409f	2089 x 1398	2100 x 1412
21 x 14.9 M	2027 x 925/509f	2089 x 1498	2100 x 1512
21 x 17 M	2027 x 825/825f	2089 x 1714	2100 x 1728
21 x 19 M	2027 x 925/925f	2089 x 1914	2100 x 1928

Danish market, natural plywood, single door dimensions table (mm)

M Size	Door leaf size	Frame outside dimension	Door way
19.1 x 9.1 M	1816 x 827	1878 x 888	1890 x 900
19.1 x 9.7 M	1816 x 887	1878 x 948	1890 x 960
20.1 x 9.1 M	1916 x 827	1978 x 888	1990 x 900
20.1 x 9.7 M	1916 x 887	1978 x 948	1990 x 960
20.8 x 9.1 M	1988 x 827	2050 x 888	2060 x 900
20.8 x 9.7 M	1988 x 887	2050 x 948	2060 x 960
20.8 x 10.1 M	1988 x 927	2050 x 988	2060 x 1000
21.1 x 9.1 M	2018 x 827	2080 x 888	2090 x 900
21.1 x 9.7 M	2018 x 887	2080 x 948	2090 x 960
21.45 x 9.1 M	2053 x 827	2115 x 888	2125 x 900
21.45 x 9.7 M	2053 x 887	2115 x 948	2125 x 960
21.45 x 10.1 M	2053 x 927	2115 x 988	2125 x 1000



GENERAL INFORMATION

Use	Painted product for externally use
Marking	CE / European
Standard accessories	Lock case: ASSA-565; hinges: 3248 - 2 pcs.; Lock plate: 0034 ZN; Silicone-based sealing strip.
Glass	Transparent single-chamber glass unit (double glass -12mm) with PVC plastic glass list
Frames	The frame set is included. Possible to choose from: 42x105, 42x115, 42x105NOR, 42x115NOR
Thresholds	The threshold is included. Hardwood impregnated 26x105, 26x115
Other accessories and services	There is a possibility to choose other accessories and services according optimal plus and master plus, but the quantity of products must meet the requirements of the optimal category
Units per pallet	Frame 42x105 - 9 pcs. a pallet consist one model and one size to all products Frame 42x115 - 7 pcs. a pallet consist one model and one size to all products

Features of door construction

 CE TESTED PRODUCT The product is tested and meet the European requirements	 PAINTED PRODUCT The surface of the product is painted using eco-friendly high quality water based paint. Standard color: NCS S0502-Y, gloss 25
 MASSIVE CONSTRUCTION Massive frame construction for external products, polystyrene used in the construction allows to ensure low thermal transmittance	 REPAINTING POSSIBILITY The painted surface of the product is suitable for repainting of any type and in any manner
 DOOR LEAF THICKNESS The door leaf thickness is 62mm	 3 LAYERS OF COATING To get the highest quality the surface of the product is covered with 3 layers 1 layer - impregnation, 1 layer - primer, 1 layer - paint
 THERMAL TRANSMITTANCE The product have distinctive thermal insulation properties. $U = 0.91 \text{ W/m}^2\text{K}$	 DIFFERENT COLORS OPTION The product can be painted in other colors by choosing from the NCS and RAL color palette
 SOUND RESISTANCE Door leaf structure is produced for sound resistance up to 31dB	 WARRANTY 5 year quality guarantee provided by manufacturer
 NON STANDARD DIMENSIONS The product may be produced in non-standard sizes	 WARRANTY 7 year guarantee for door blade form



opt0

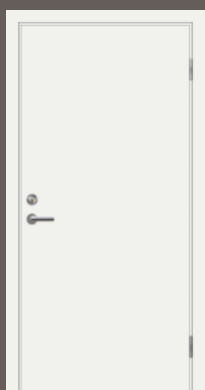

opt0 dobbelt
(M13-M15)



opt0 dobbelt
(M13.9-M14.9)



opt0 dobbelt
(M17-M19)



opt1

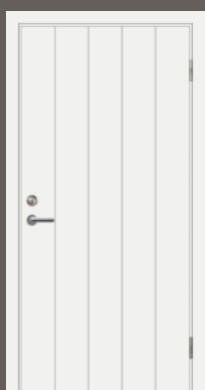

opt1 dobbelt
(M13-M15)

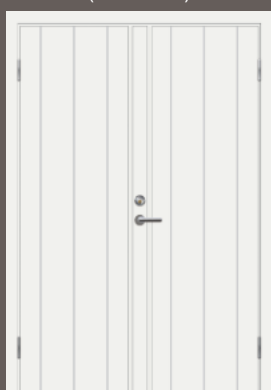

opt1 dobbelt
(M13.9-M14.9)



opt1 dobbelt
(M17-M19)

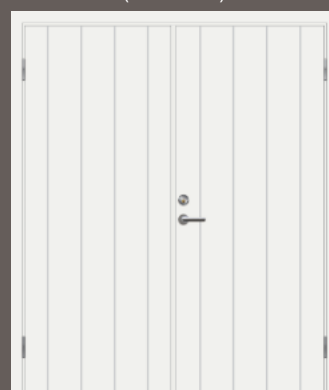

optSL-G0
glass



1. Finger jointed pine wood frame
2. Aluminium panels
3. Polystyrene core
4. Rubber seals
5. Single-chamber glass unit (double glass)
6. PVC plastic glass list
7. HDF panel surface 4mm
8. Wood
9. Threshold

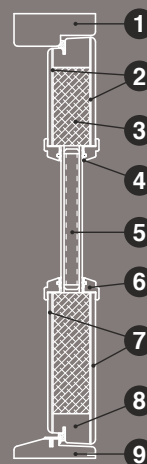
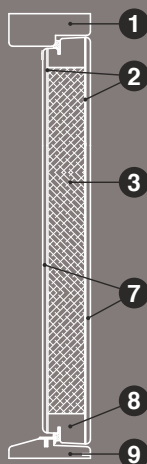

FEATURES OF MASTER PLUS LINE



Custom dimensions

Possibility to choose custom size

Hidden hinges

Possibility to choose hidden hinges



Lockcase selection

Available multiple ASSA and DORMA locks

Different color options

Any color from NCS/RAL pallets



Different glass types

Available in matt or costwold glass

Extra coating layer

To obtain more intensive color in dark shades



EXTENDED
MANUFACTURER WARRANTY
UP TO 7 YEARS



EXTENDED
DOOR BLADE FORM WARRANTY
UP TO 10 YEARS

torso has created a unique **master** plus production line for exterior doors to satisfy every possible customer demand and desire



ASSA 565 LOCK CASE

Available for exterior doors
Locking: Lockable with Scandinavian oval cylinder
Frame plate: 0034
Finish: Zinc



DORMA 9192 LOCK CASE

Available for exterior doors
Locking: Double round cylinder
Frame plate: DS9002
Finish: Zinc
Safe and accurate 7-point system



ASSA 8765 LOCK CASE

Available for exterior doors
Locking: Double oval cylinder
Finish: White zinc
The lock case housing security class III



ASSA 2002 LOCK CASE

Available for interior doors
Locking: Double round cylinder
Finish: White zinc
The lock case housing security class III



ASSA FIX M5001, 3 POINT LOCKING

Available for exterior doors
Locking: Lockable with Scandinavian oval cylinder
Multi point lock for doors
Lockable with 360 degree key turn



ASSA FIX 2025, 3 POINT LOCKING

Available for exterior doors
Locking: Accepts Scandinavian cylinder rather than standard euro profile
Multi point lock for doors
Lockable with 360 degree key turn



ASSA 2002 LOCK CASE TRIOVING CYLINDER

Available for interior doors
Locking: TrioVing 5545 cylinder
Finish: White zinc
The lock case housing security class III



DORMA 9192 LOCK CASE DORMA CYLINDER

Available for exterior doors
Locking: Double oval cylinder
Frame plate: DS9002
Finish: White zinc
The lock case housing security class III



DORMA 9192 LOCK CASE TRIOVING CYLINDER

Available for exterior doors
Locking: TrioVing 5545 cylinder
Frame plate: DS9002
Finish: Zinc
Safe and accurate 7-point system



YALE DOORMAN V2N - SMART LOCK

Available for exterior doors
Speaking instructions in either Swedish, Norwegian, Danish or English
UV-protected surface that can withstand sun, rain and moisture
Automatic locking
Up to 10 RFID access tags with 4-digit codes
Up to 10 six-digit user codes
Temporary codes



3248 HINGES

Adjustable: Vertical and horizontal
Tested for 200 000 closing / opening cycles
Finish: Zinc
Load capacity: 60kg for 2 pcs.

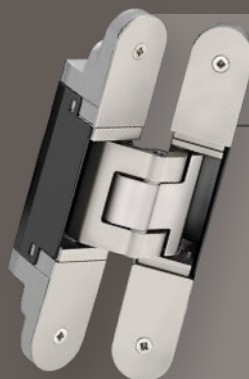

SIMONS TECTUS TE 310 3D HIDDEN HINGES

Adjustable: 3 way +/- 3 mm
CE certified
Finish: F2 coloured 125
Load capacity: ~60kg for 2 pcs.

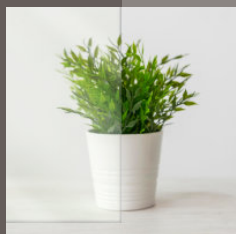

CLEAR GLASS

Finish: Transparent clear glass
Thickness: Double glass - 12mm
Single chamber glass packet
Tempered glass: Yes

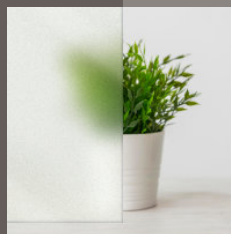

MATT GLASS

Finish: One side matt and other side glossy
Thickness: Double glass - 12mm
Single chamber glass packet
Tempered glass: Yes



COTSWOLD GLASS

Finish: Textured glass
Thickness: Double glass - 12mm
Single chamber glass packet
Tempered glass: Yes

MOST POPULAR NCS / RAL COLORS:

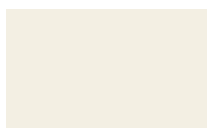

NCS S0502-Y
Standard White

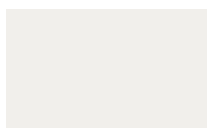

NCS S0500-N
White



NCS S6500-N
Grey



NCS S9000-N
Black



RAL 7016
Dark Grey



NCS S4040-Y80R
Red



NCS S5040-Y80R
Burgundy

More color codes can be found:

NCS color palette: [Click to visit](#)

RAL color palette: [Click to visit](#)

opt0

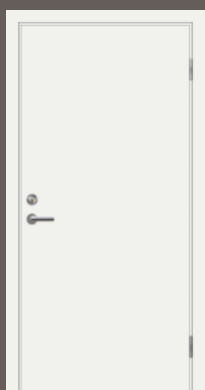

opt0 dobbelt
(M13-M15)



opt0 dobbelt
(M13.9-M14.9)



opt0 dobbelt
(M17-M19)



opt1

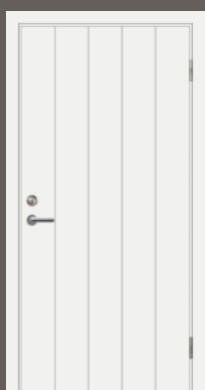

opt1 dobbelt
(M13-M15)

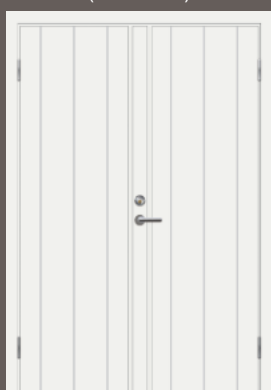

opt1 dobbelt
(M13.9-M14.9)



opt1 dobbelt
(M17-M19)

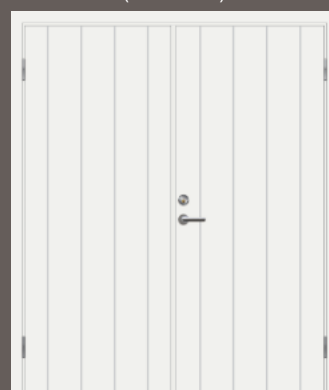

optSL-P



1. Finger jointed pine wood frame
2. Aluminium panels
3. Polystyrene core
4. HDF panel surface 4mm
5. Wood
6. Threshold

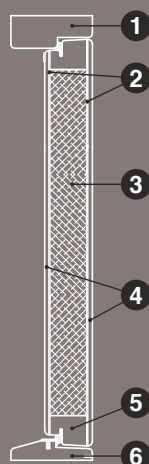

opt6

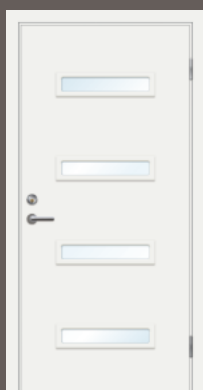

opt6 dobbelt
(M13-M15)



opt6 dobbelt
(M13.9-M14.9)



opt6 dobbelt
(M17-M19)



opt10

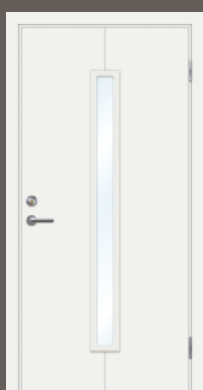

opt10 dobbelt
(M13-M15)



opt10 dobbelt
(M13.9-M14.9)



opt10 dobbelt
(M17-M19)

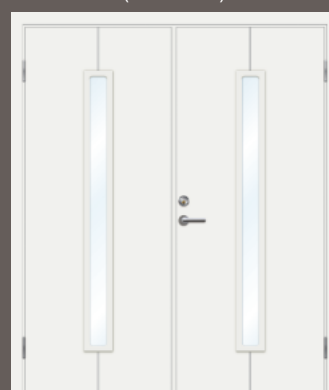

optSL-G0
glass



optSL-G0
2B2 glass



1. Finger jointed pine wood frame
2. Aluminium panels
3. Polystyrene core
4. Rubber seals
5. Single-chamber glass unit (double glass)
6. PVC plastic glass list
7. HDF panel surface 4mm
8. Wood
9. Threshold

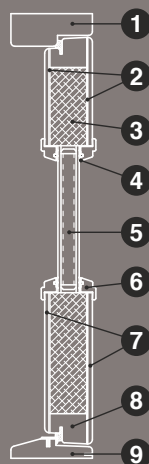

Painted, single door dimensions table (mm)

M Size	Door leaf size	Frame outside dimension	Door way
18 x 8 M	1740 x 725	1789 x 786	1900 x 800
18 x 9 M	1740 x 825	1789 x 886	1900 x 900
18 x 10 M	1740 x 925	1789 x 986	1900 x 1000
19 x 8 M	1840 x 725	1889 x 786	1900 x 800
19 x 9 M	1840 x 825	1889 x 886	1900 x 900
19 x 10 M	1840 x 925	1889 x 986	1900 x 1000
20 x 8 M	1940 x 725	1989 x 786	2000 x 800
20 x 9 M	1940 x 825	1989 x 886	2000 x 900
20 x 10 M	1940 x 925	1989 x 986	2000 x 1000
21 x 8 M	2040 x 725	2089 x 786	2100 x 800
21 x 9 M	2040 x 825	2089 x 886	2100 x 900
21 x 10 M	2040 x 925	2089 x 986	2100 x 1000

Painted, double door dimensions table (mm)

M Size	Door leaf size	Frame outside dimension	Door way
18 x 13 M	1740 x 661/561f	1889 x 1286	1900 x 1300
18 x 14 M	1740 x 711/611f	1889 x 1386	1900 x 1400
18 x 15 M	1740 x 761/661f	1889 x 1486	1900 x 1500
18 x 13.9 M	1740 x 925/409f	1889 x 1398	1900 x 1412
18 x 14.9 M	1740 x 925/509f	1889 x 1498	1900 x 1512
18 x 17 M	1740 x 825/825f	1889 x 1714	1900 x 1728
18 x 19 M	1740 x 925/925f	1889 x 1914	1900 x 1928
19 x 13 M	1840 x 661/561f	1889 x 1286	1900 x 1300
19 x 14 M	1840 x 711/611f	1889 x 1386	1900 x 1400
19 x 15 M	1840 x 761/661f	1889 x 1486	1900 x 1500
19 x 13.9 M	1840 x 925/409f	1889 x 1398	1900 x 1412
19 x 14.9 M	1840 x 925/509f	1889 x 1498	1900 x 1512
19 x 17 M	1840 x 825/825f	1889 x 1714	1900 x 1728
19 x 19 M	1840 x 925/925f	1889 x 1914	1900 x 1928
20 x 13 M	1940 x 661/561f	1989 x 1286	2000 x 1300
20 x 14 M	1940 x 711/611f	1989 x 1386	2000 x 1400
20 x 15 M	1940 x 761/661f	1989 x 1486	2000 x 1500
20 x 13.9 M	1940 x 925/409f	1989 x 1398	2000 x 1412
20 x 14.9 M	1940 x 925/509f	1989 x 1498	2000 x 1512
20 x 17 M	1940 x 825/825f	1989 x 1714	2000 x 1728
20 x 19 M	1940 x 925/925f	1989 x 1914	2000 x 1928
21 x 13 M	2040 x 661/561f	2089 x 1286	2100 x 1300
21 x 14 M	2040 x 711/611f	2089 x 1386	2100 x 1400
21 x 15 M	2040 x 761/661f	2089 x 1486	2100 x 1500
21 x 13.9 M	2040 x 925/409f	2089 x 1398	2100 x 1412
21 x 14.9 M	2040 x 925/509f	2089 x 1498	2100 x 1512
21 x 17 M	2040 x 825/825f	2089 x 1714	2100 x 1728
21 x 19 M	2040 x 925/925f	2089 x 1914	2100 x 1928

Painted, double door dimensions table (mm)

M Size	Door leaf size	Frame outside dimension	Door way
20 x 4 M	-	1989 x 398	2000 x 400
21 x 4 M	-	2089 x 398	2100 x 400

Danish market, natural plywood, single door dimensions table (mm)

M Size	Door leaf size	Frame outside dimension	Door way
19.1 x 9.1 M	1832 x 827	1878 x 888	1890 x 900
19.1 x 9.7 M	1832 x 887	1878 x 948	1890 x 960
20.1 x 9.1 M	1932 x 827	1978 x 888	1990 x 900
20.1 x 9.7 M	1932 x 887	1978 x 948	1990 x 960
20.8 x 9.1 M	2002 x 827	2050 x 888	2060 x 900
20.8 x 9.7 M	2002 x 887	2050 x 948	2060 x 960
20.8 x 10.1 M	2002 x 927	2050 x 988	2060 x 1000
21.1 x 9.1 M	2032 x 827	2080 x 888	2090 x 900
21.1 x 9.7 M	2032 x 887	2080 x 948	2090 x 960
21.45 x 9.1 M	2067 x 827	2115 x 888	2125 x 900
21.45 x 9.7 M	2067 x 887	2115 x 948	2125 x 960
21.45 x 10.1 M	2067 x 927	2115 x 988	2125 x 1000