

 torso
doors



DOORS FOR THE PERFECT HOME
RELIABILITY. HIGH QUALITY

TABLE OF CONTENT

optimal

Painted, massive framed doors

04

optimal

Painted, light cell and formpressed doors

11

optimal

Painted, compact cell and formpressed doors

13

master plus

Additional accessories

15

master plus

Available designs

18

dimensions

Standard size table

23

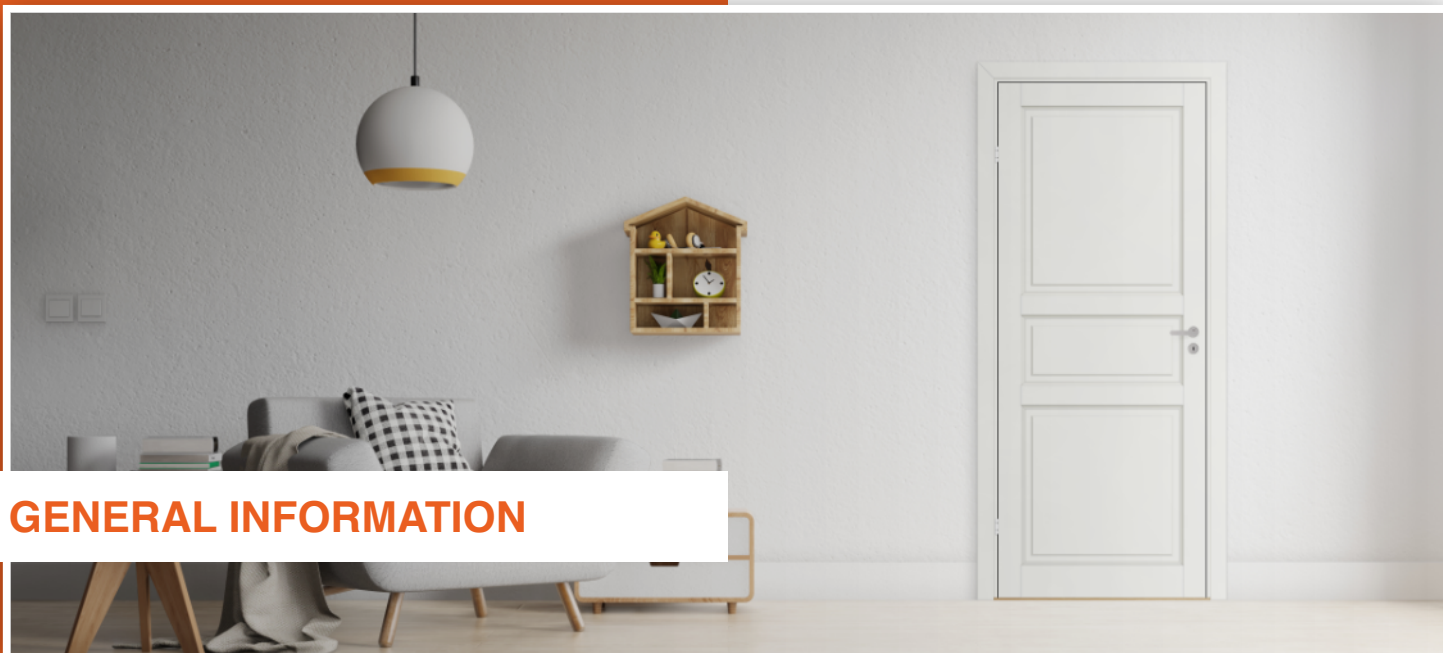

GENERAL INFORMATION

Use	Use internally in heated and well ventilated premises
Class	Unclassified
Standard accessories	Lock case: 2014, hinges: 6540KS briks 2 pcs., Fixation for double doors 849 2 pcs.
Frames	The frames are sold separately. Doors in this category can be fit with all frame profiles and sizes from interior optimal and master plus frame categories
Thresholds	The thresholds are sold separately. Doors in this category can be fit with all threshold profiles and sizes from interior master plus frame category
Other accessories and services	There is a possibility to choose other product colors according optimal plus, but the quantity of products must meet the requirements of the optimal category
Units per pallet	20 pcs. a pallet consist one model and one size to all products

Features of door construction



MASSIVE CONSTRUCTION

Door construction is made of combined profiles: vertical - made of pressed wood chips and wood, horizontal - made of finger-jointed wooden core



DOOR LEAF THICKNESS

The door leaf thickness is 40mm



SOUND RESITANCE

Door leaf structure is produced for sound resistance up to 23dB



NON STANDARD DIMENSIONS

The product may be produced in non-standard size



WARRANTY

3 years quality guarantee provided by manufacturer



PAINTED PRODUCT

The surface of the product is painted using eco-friendly high quality water based paint. Standard color: NCS S0502-Y, gloss 25



REPAINTING POSSIBILITY

The painted surface of the product is suitable for repainting of any type and in any manner



2 LAYERS OF COATING

The surface of the product has 2 layers of coating: 1 layer of primer, 1 layer of paint



DIFFERNET COLORS OPTION

The product can be painted in other colors by choosing from the NCS and RAL color palette



optFinland



optNorge



VERTICAL PROFILE

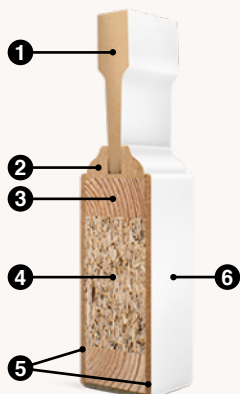

PROFILE CONSTRUCTION

1. Medium density fiberboard panel
2. Medium density fiberboard
3. Wood
4. Medium density particle
5. High density fiberboard
6. Painted surface

HORIZONTAL PROFILE

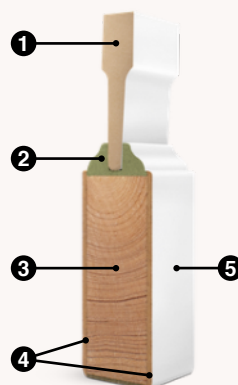

PROFILE CONSTRUCTION

1. Medium density fiberboard panel
2. Medium density fiberboard
3. Wood
4. High density fiberboard
5. Painted surface

optFinland 6SP



optFinland 6SP
Dobbelt Fixed



optFinland 6SP
Dobbelt



optNorge 10SP



optNorge 10SP
Dobbelt Fixed



optNorge 10SP
Dobbelt



optIsland 12SP



optIsland 12SP
Dobbelt Fixed



optIsland 12SP
Dobbelt



VERTICAL PROFILE

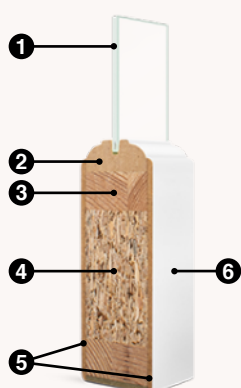

PROFILE CONSTRUCTION

1. Medium density fiberboard panel
2. Medium density fiberboard
3. Wood
4. Medium density particle
5. High density fiberboard
6. Painted surface

HORIZONTAL PROFILE

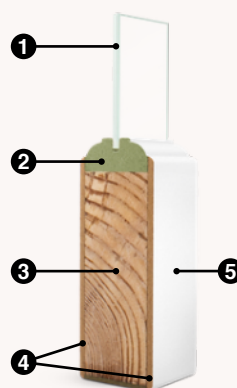

PROFILE CONSTRUCTION

1. Medium density fiberboard panel
2. Medium density fiberboard
3. Wood
4. High density fiberboard
5. Painted surface

optTrend100-1



optTrend100-3



VERTICAL PROFILE

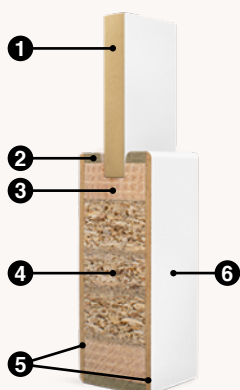

PROFILE CONSTRUCTION

1. Medium density fiberboard panel
2. Medium density fiberboard
3. Wood
4. Medium density particle
5. High density fiberboard
6. Painted surface

HORIZONTAL PROFILE

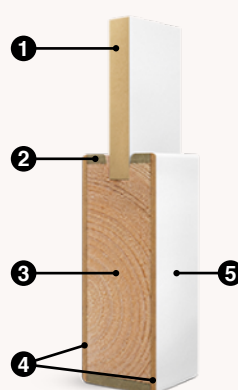

PROFILE CONSTRUCTION

1. Medium density fiberboard panel
2. Medium density fiberboard
3. Wood
4. High density fiberboard
5. Painted surface

optTrend100-1SP



optTrend100-1SP
Dobbelt Fixed



optTrend100-1SP
Dobbelt



optTrend100-3SP



optTrend100-3SP
Dobbelt Fixed



optTrend100-3SP
Dobbelt



VERTICAL PROFILE

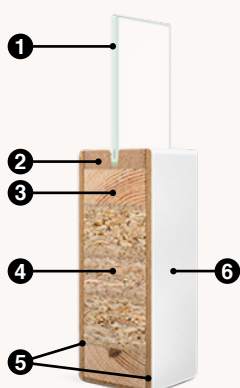

PROFILE CONSTRUCTION

1. Medium density fiberboard panel
2. Medium density fiberboard
3. Wood
4. Medium density particle
5. High density fiberboard
6. Painted surface

HORIZONTAL PROFILE

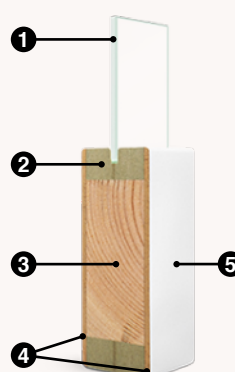

PROFILE CONSTRUCTION

1. Medium density fiberboard panel
2. Medium density fiberboard
3. Wood
4. High density fiberboard
5. Painted surface

optTrend120-1



optTrend120-3



VERTICAL PROFILE

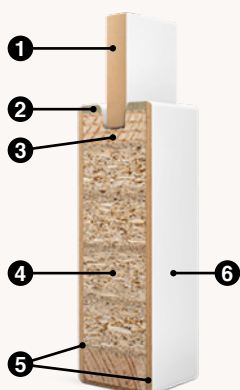

PROFILE CONSTRUCTION

1. Medium density fiberboard panel
2. Medium density fiberboard
3. Wood
4. Medium density particle
5. High density fiberboard
6. Painted surface

HORIZONTAL PROFILE

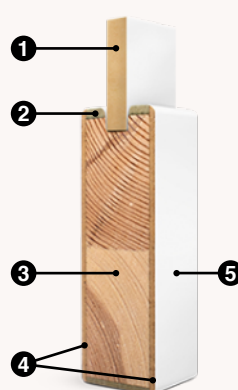

PROFILE CONSTRUCTION

1. Medium density fiberboard panel
2. Medium density fiberboard
3. Wood
4. High density fiberboard
5. Painted surface

optTrend120-1SP



optTrend120-1SP
Dobbelt Fixed



optTrend120-1SP
Dobbelt



optTrend120-3SP



optTrend120-3SP
Dobbelt Fixed



optTrend120-3SP
Dobbelt



VERTICAL PROFILE

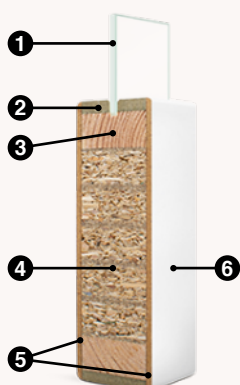

PROFILE CONSTRUCTION

1. Medium density fiberboard panel
2. Medium density fiberboard
3. Wood
4. Medium density particle
5. High density fiberboard
6. Painted surface

HORIZONTAL PROFILE

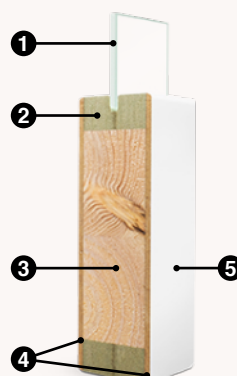

PROFILE CONSTRUCTION

1. Medium density fiberboard panel
2. Medium density fiberboard
3. Wood
4. High density fiberboard
5. Painted surface



GENERAL INFORMATION

Use	Use internally in heated and well ventilated premises
Class	Unclassified
Standard accessories	Lock case: 2014, hinges: 6540KS briks 2 pcs., Fixation for double doors 849 2 pcs.
Frames	The frames are sold separately. Doors in this category can be fit with all frame profiles and sizes from interior optimal and master plus frame categories
Thresholds	The thresholds are sold separately. Doors in this category can be fit with all threshold profiles and sizes from interior master plus frame category
Other accessories and services	There is a possibility to choose other product colors according optimal plus, but the quantity of products must meet the requirements of the optimal category
Units per pallet	25 pcs. a pallet consist one model and one size to all products

Features of door construction



LIGHT CONSTRUCTION

The door construction is made of honeycomb core, so this product is extremely light



DOOR LEAF THICKNESS

The door leaf thickness is 40mm



SOUND RESITANCE

Door leaf structure is produced for sound resistance up to 13dB



EDGE BANDING

High-quality edge banding with melamine/veneer



WARRANTY

3 years quality guarantee provided by manufacturer



PAINTED PRODUCT

The surface of the product is painted using eco-friendly high quality water based paint. Standard color: NCS S0502-Y, gloss 25



REPAINTING POSSIBILITY

The painted surface of the product is suitable for repainting of any type and in any manner



2 LAYERS OF COATING

The surface of the product has 2 layers of coating: 1 layer of primer, 1 layer of paint



DIFFERNET COLORS OPTION

The product can be painted in other colors in optimal plus line. NCS S7500-N, NCS S8500-N



optLana



optFinland 3SYM
Form pressed



optNorge 4SYM
Form pressed



LIGHT CELL

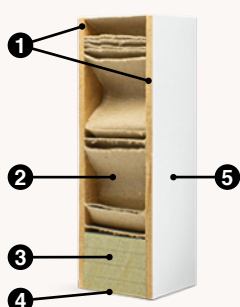

PROFILE CONSTRUCTION

1. High density fiberboard
2. Carton honeycomb core
3. Medium density fiberboard
4. Melamine edgeband
5. Painted surface

LIGHT FORM PRESS

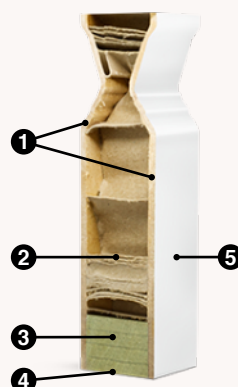

PROFILE CONSTRUCTION

1. High density fiberboard
2. Carton honeycomb core
3. Medium density fiberboard
4. Melamine edgeband
5. Painted surface



GENERAL INFORMATION

Use	Use internally in heated and well ventilated premises
Class	Unclassified
Standard accessories	Lock case: 2014, hinges: 6540KS briks 2 pcs., Fixation for double doors 849 2 pcs.
Frames	The frames are sold separately. Doors in this category can be fit with all frame profiles and sizes from interior optimal and master plus frame categories
Thresholds	The thresholds are sold separately. Doors in this category can be fit with all threshold profiles and sizes from interior master plus frame category
Other accessories and services	There is a possibility to choose other product colors according optimal plus, but the quantity of products must meet the requirements of the optimal category
Units per pallet	20 pcs. a pallet consist one model and one size to all products

Features of door construction



MASSIVE CONSTRUCTION

The massive framed construction is designed for the product of planar pressing, providing a very high quality of stability



DOOR LEAF THICKNESS

The door leaf thickness is 40mm



SOUND RESITANCE - TUBULAR CORE

Door leaf structure is produced for sound resistance up to 28dB



SOUND RESITANCE - MASSIVE CORE

Door leaf structure is produced for sound resistance up to 36dB



WARRANTY

3 years quality guarantee provided by manufacturer



PAINTED PRODUCT

The surface of the product is painted using eco-friendly high quality water based paint. Standard color: NCS S0502-Y, gloss 25



REPAINTING POSSIBILITY

The painted surface of the product is suitable for repainting of any type and in any manner



2 LAYERS OF COATING

The surface of the product has 2 layers of coating: 1 layer of primer, 1 layer of paint



DIFFERENT COLORS OPTION

The product can be painted in other colors with optimal plus line. NCS S7500-N, NCS S8500-N



EDGE BANDING

High-quality edge banding with melamine/veneer



optLana
Stable



optFinland 3SYM
Kompakt



STABLE CELL

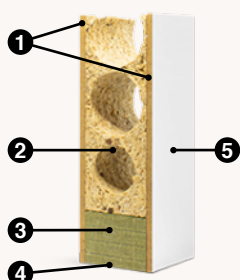

PROFILE CONSTRUCTION

1. High density fiberboard
2. Chipboard tubular core
3. Medium density fiberboard
4. Melamine edgeband
5. Painted surface

MASSIVE FORM PRESSED

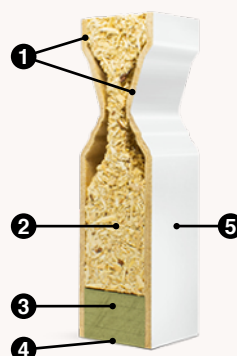

PROFILE CONSTRUCTION

1. High density fiberboard
2. Chipboard core
3. Medium density fiberboard
4. Melamine edgeband
5. Painted surface

FEATURES OF OPTIMAL / MASTER PLUS LINE



Custom dimensions

Possibility to choose custom size



35mm thickness

Available in additional 35mm door thickness



Bathroom operation

The doors are covered with a moisture-resistant material



Lockcase selection

Available multiple AGB and ASSA locks



Overlap function

Doors overlapping the frame



Sliding operation

Milling at the bottom of the door

Hidden hinges

Possibility to choose hidden hinges



Different glass types

Available in matt or facet glass



Handle and lock diameter

Available options: 40mm x 2 / 40mm x 1
20mm x 2 / 20mm x 1



Different color options

Any color from NCS/RAL pallets



Extra coating layer

To obtain more intensive color in dark shades



EXTENDED
5 YEARS WARRANTY

torso has created a unique **master plus** production line for interior doors to satisfy every possible customer demand and desire



ABLOY 2014 LOCK CASE

Available for interior doors
Locking: "Buratino" key
Frame plate: 0045
Finish: FE/ZN - silver, FE/JME - brown
Fire resistance



ABLOY 2018 LOCK CASE

Available for interior doors
Locking: DIN standard cylinder
Frame plate: 0045
Finish: FE/ZN - silver, FE/JME - brown
Fire resistance



AGB WC LOCK CASE

Available for interior doors
Locking: WC lock
Frame plate: 0045
Finish: Stainless steel finish
Magnetic catch
Close quietly



AGB BB LOCK CASE

Available for interior doors
Locking: "Buratino" key
Frame plate: 0045
Finish: Stainless steel finish
Magnetic catch
Close quietly



AGB PZ LOCK CASE

Available for interior doors
Locking: DIN standard cylinder
Frame plate: 0045
Finish: Stainless steel finish
Magnetic catch
Close quietly



ROCA PULL RING

Available for sliding doors
Locking: -
Frame plate: -
Finish: Dull nickel plated and chrome-plated



ROCA BOWL HANDLE

Available for sliding doors
Finish: Dull nickel plated or chrome-plated



ABLOY 4249 LOCK CASE

Available for sliding doors
Locking: WC lock
Frame plate: 4662
Finish: Galvanized

ABLOY 6540KS HINGES

Adjustable: vertically +/- 2 mm
Tested for 200 000 closing / opening cycles
Finish: White or brown
Load capacity: ~40kg for 2 pcs.

ESTETIC 978 3DME HIDDEN HINGES

Adjustable: 3 way +/- 3 mm
Tested for 200 000 closing / opening cycles
Finish: Nickel Satin 8054
Load capacity: ~50kg for 2 pcs.

CLEAR GLASS

Finish: Transparent clear glass
Thickness: 4mm
Tempered glass: Yes

MATT GLASS

Finish: One side matt and other side glossy
Thickness: 4mm
Tempered glass: Yes

FACET GLASS

Finish: The glass is slightly risen
in the middle, transparent clear glass
Thickness: 4mm
Tempered glass: Yes

MOST POPULAR NCS / RAL COLORS:

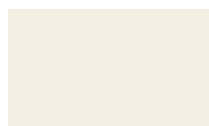

NCS S0502-Y
Standard White



NCS S1002-Y50R
Cream



NCS S0500-N
Light Grey



NCS S7500-N
Grey



NCS S9000-N
Black

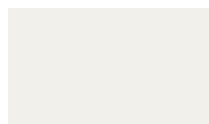

RAL 9016
Cream



RAL 7016
Grey



RAL 9005
Black

More color codes can be found:

NCS color palette: [Click to visit](#)

RAL color palette: [Click to visit](#)

mstrFinland



mstrNorge



mstrDannebrog



mstrSwedish



mstrFinland
DS1



mstrFinland
DS2



mstrFinland
DS3



mstrFinland
DS1-TR



mstrFinland
DS3-TR



mstrFinland 6SP



mstrNorge 10SP



mstrIsland 12SP



MASSIVE
Classic
FILLING PROFILE

MASSIVE
Classic
FILLING PROFILE

MASSIVE
Classic
FILLING PROFILE

MASSIVE
Classic
GLASS PROFILE

mstrTrend100-1



mstrTrend100-3



mstrTrend100-4



mstrTrend100-1SP



mstrTrend100-3SP



mstrTrend100-4SP



mstrTrend120-1



mstrTrend120-3



mstrTrend120-4



mstrTrend120-1SP



mstrTrend120-3SP



mstrTrend120-4SP



MASSIVE
Trend100
FILLING PROFILE

MASSIVE
Trend100
GLASS PROFILE

MASSIVE
Trend120
FILLING PROFILE

MASSIVE
Trend120
GLASS PROFILE

mstrTrend100/120
DS1-CL



mstrTrend100/120
DS3-CL



mstrTrend100/120
DS1-RNG1



mstrTrend100/120
DS1-RNG3



mstrTrend100/120
DS3-RNG1



mstrTrend100/120
DS3-RNG3



mstrTrend100/120
DS1-SQU1



mstrTrend100/120
DS1-SQU4



mstrTrend100/120
DS3-SQU3



MASSIVE
Trend DS
FILLING PROFILE

MASSIVE
Trend RNG
GLASS PROFILE

MASSIVE
Trend SQU
GLASS PROFILE

mstrLana



mstrFinland 3SYM
Formpressed



mstrNorge 4SYM
Formpressed



HONEYCOMB CORE
Light
CELL DOOR

HONEYCOMB CORE
Light
FORMPRESSED DOOR

mstrTrend100-1



STABLE
Compact
CELL DOOR

mstrLana
DS-RNG1



mstrLana
DS-RNG3

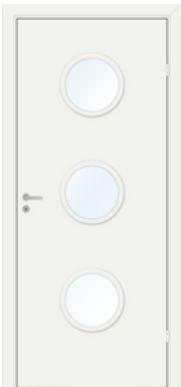

mstrLana
DS-SQU1



mstrLana
DS-SQU4



STABLE
Compact
CELL GLASS DOOR

mstrLana
Massive



MASSIVE
Compact
CELL DOOR

mstrFinland
Compact



MASSIVE
Compact
FORMPRESSED DOORS

M Size				Door leaf size	Frame outside dimension	Door way
19	x	4	M	1840 x 398	-	-
19	x	5	M	1840 x 498	-	-
19	x	7	M	1840 x 625	1889 x 687	1900 x 710
19	x	8	M	1840 x 725	1889 x 787	1900 x 810
19	x	9	M	1840 x 825	1889 x 887	1900 x 910
19	x	10	M	1840 x 925	1889 x 987	1900 x 1010
19	x	11	M ^{M7 + M4}	1840 x 625 + 398	1889 x 1092	1900 x 1114
19	x	12	M ^{M8 + M4}	1840 x 725 + 398	1889 x 1192	1900 x 1214
19	x	13	M ^{M9 + M4}	1840 x 825 + 398	1889 x 1292	1900 x 1314
19	x	14	M ^{M10 + M4}	1840 x 925 + 398	1889 x 1392	1900 x 1414
19	x	13.1	M ^{M7 + M7}	1840 x 625 + 625	1889 x 1319	1900 x 1340
19	x	15	M ^{M8 + M8}	1840 x 725 + 725	1889 x 1519	1900 x 1540
19	x	17	M ^{M9 + M9}	1840 x 825 + 825	1889 x 1719	1900 x 1740
19	x	19	M ^{M10 + M10}	1840 x 925 + 925	1889 x 1919	1900 x 1940
20	x	4	M	1940 x 398	-	-
20	x	5	M	1940 x 498	-	-
20	x	7	M	1940 x 625	1989 x 687	2000 x 710
20	x	8	M	1940 x 725	1989 x 787	2000 x 810
20	x	9	M	1940 x 825	1989 x 887	2000 x 910
20	x	10	M	1940 x 925	1989 x 987	2000 x 1010
20	x	11	M ^{M7 + M4}	1940 x 625 + 398	1989 x 1092	2000 x 1114
20	x	12	M ^{M8 + M4}	1940 x 725 + 398	1989 x 1192	2000 x 1214
20	x	13	M ^{M9 + M4}	1940 x 825 + 398	1989 x 1292	2000 x 1314
20	x	14	M ^{M10 + M4}	1940 x 925 + 398	1989 x 1392	2000 x 1414
20	x	13.1	M ^{M7 + M7}	1940 x 625 + 625	1989 x 1319	2000 x 1340
20	x	15	M ^{M8 + M8}	1940 x 725 + 725	1989 x 1519	2000 x 1540
20	x	17	M ^{M9 + M9}	1940 x 825 + 825	1989 x 1719	2000 x 1740
20	x	19	M ^{M10 + M10}	1940 x 925 + 925	1989 x 1919	2000 x 1940
20.5	x	4	M	2000 x 398	-	-
20.5	x	5	M	2000 x 498	-	-
20.5	x	7	M	2000 x 625	2049 x 687	2060 x 710
20.5	x	8	M	2000 x 725	2049 x 787	2060 x 810
20.5	x	9	M	2000 x 825	2049 x 887	2060 x 910
20.5	x	10	M	2000 x 925	2049 x 987	2060 x 1010
20.5	x	11	M ^{M7 + M4}	2000 x 625 + 398	2049 x 1092	2060 x 1114
20.5	x	12	M ^{M8 + M4}	2000 x 725 + 398	2049 x 1192	2060 x 1214
20.5	x	13	M ^{M9 + M4}	2000 x 825 + 398	2049 x 1292	2060 x 1314
20.5	x	14	M ^{M10 + M4}	2000 x 925 + 398	2049 x 1392	2060 x 1414
20.5	x	13.1	M ^{M7 + M7}	2000 x 625 + 625	2049 x 1319	2060 x 1340
20.5	x	15	M ^{M8 + M8}	2000 x 725 + 725	2049 x 1519	2060 x 1540
20.5	x	17	M ^{M9 + M9}	2000 x 825 + 825	2049 x 1719	2060 x 1740
20.5	x	19	M ^{M10 + M10}	2000 x 925 + 925	2049 x 1919	2060 x 1940
21	x	4	M	2040 x 398	-	-
21	x	5	M	2040 x 498	-	-
21	x	7	M	2040 x 625	2089 x 687	2100 x 710
21	x	8	M	2040 x 725	2089 x 787	2100 x 810
21	x	9	M	2040 x 825	2089 x 887	2100 x 910
21	x	10	M	2040 x 925	2089 x 987	2100 x 1010
21	x	11	M ^{M7 + M4}	2040 x 625 + 398	2089 x 1092	2100 x 1114
21	x	12	M ^{M8 + M4}	2040 x 725 + 398	2089 x 1192	2100 x 1214
21	x	13	M ^{M9 + M4}	2040 x 825 + 398	2089 x 1292	2100 x 1314
21	x	14	M ^{M10 + M4}	2040 x 925 + 398	2089 x 1392	2100 x 1414
21	x	13.1	M ^{M7 + M7}	2040 x 625 + 625	2089 x 1319	2100 x 1340
21	x	15	M ^{M8 + M8}	2040 x 725 + 725	2089 x 1519	2100 x 1540
21	x	17	M ^{M9 + M9}	2040 x 825 + 825	2089 x 1719	2100 x 1740
21	x	19	M ^{M10 + M10}	2040 x 925 + 925	2089 x 1919	2100 x 1940

Dimensions of outside frame indicated with SWE profile frames